

5- $\frac{1}{2}$ 8RD MALE BODY
 DUCTILE IRON
 P/N 1455-0000-030

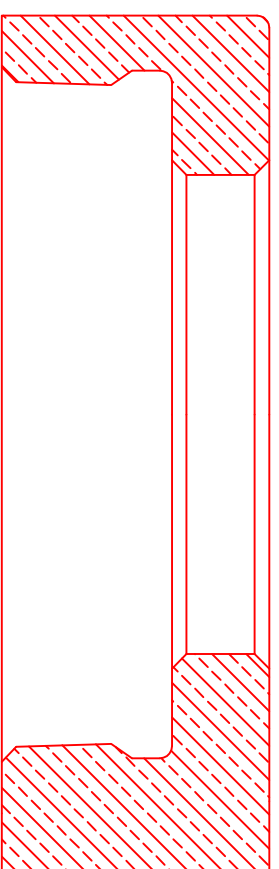

1410-0000-016

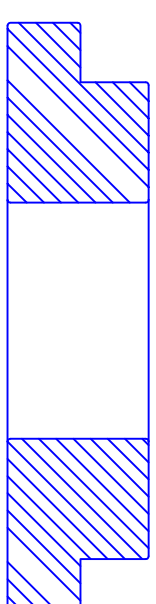

TOP PLATE
 P/N 1425-0278-004



PACKOFF RUBBER (2)
 P/N 1425-0278-003



BOTTOM PLATE
 P/N 1425-0278-002

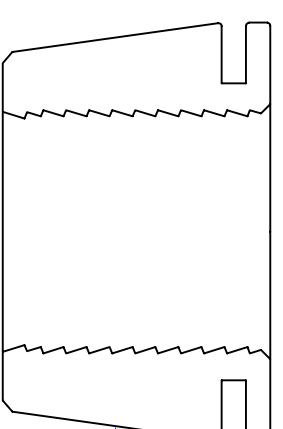

CASE HARDENED SLIPS
 P/N 1425-0278-001

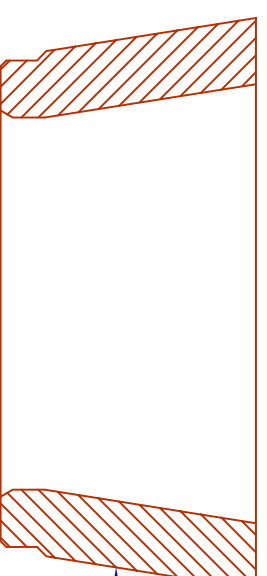

SLIP BOWL
 P/N 1401-0000-001

TOLERANCES UNLESS NOTED

| DECIMAL | X.X | X.XX | X.XXX | ANGULAR SURFACE |
|---------|-----|-------|-------|-----------------|
| | ±.1 | ±.015 | ±.005 | ±.5° |
| | | | | 125 rms |



Wellhead Systems Inc.
 710 West McVey
 Hill City, Kansas 67642

Material:

Ductile Iron
 65-45-12
 (Per API 11-IW)

5- $\frac{1}{2}$ 8rd x 2- $\frac{7}{8}$ Male Type
 "HB" Tubing Head
 All Dimensions ±.005 Unless
 Otherwise Stated

- Notes:
1. DEBURR AND REMOVE ALL SHARP EDGES
 .015 X 45° UNLESS OTHERWISE NOTED
 2. PART TO BE FREE OF MACHINE OILS AND METAL CHIPS
 3. REFERENCE API 5B AND 11-IW

P/N 1455-0278-001