

4½ 8RD MALE BODY
DUCTILE IRON
P/N 1445-0000-030

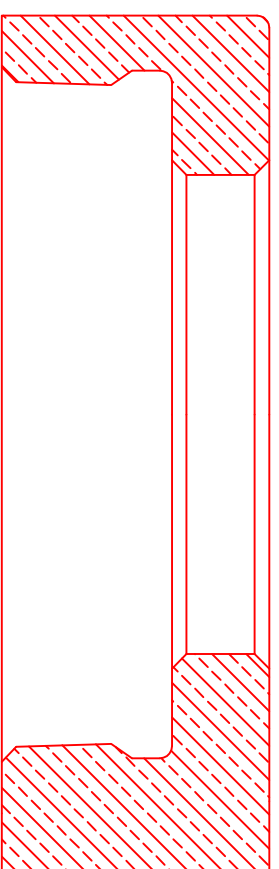

1410-0000-016

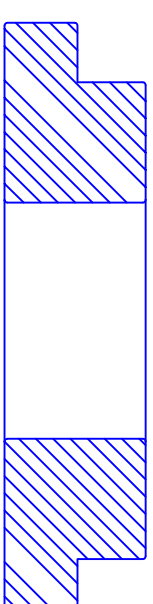

TOP PLATE
P/N 1420-0238-004



PACKOFF RUBBER (2)
P/N 1420-0238-003



BOTTOM PLATE
P/N 1420-0238-002

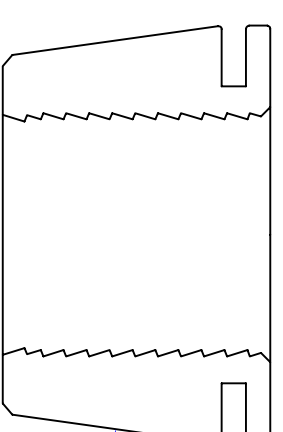

CASE HARDENED SLIPS
P/N 1420-0238-001

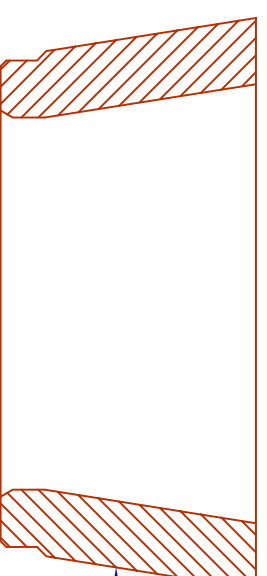

SLIP BOWL
P/N 1401-0000-001

TOLERANCES UNLESS NOTED

DECIMAL	X.X	X.XX	X.XXX	ANGULAR SURFACE
	±.1	±.015	±.005	±.5°
				125 rms



Wellhead Systems Inc.
710 West McVey
Hill City, Kansas 67642

Material:

Ductile Iron
65-45-12
(Per API 11-IW)

4-½ 8rd x 2-8 Male Type
"HB" Tubing Head
All Dimensions ±.005 Unless
Otherwise Stated

- Notes:
1. DEBURR AND REMOVE ALL SHARP EDGES
.015 X 45° UNLESS OTHERWISE NOTED
 2. PART TO BE FREE OF MACHINE OILS AND METAL CHIPS
 3. REFERENCE API 5B AND 11-IW

P/N 1445-0238-001