

7" 8RD MALE  
DUCTILE IRON BODY  
P/N 1371-0000-030

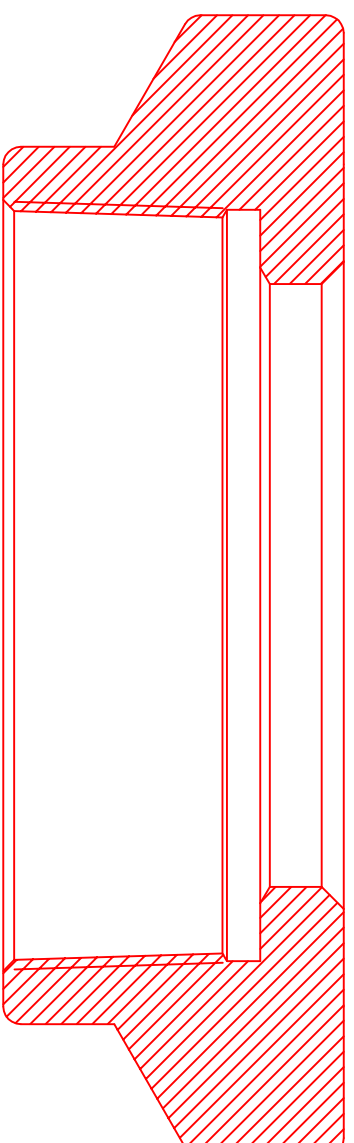

TOP CAP  
P/N 1310-0000-016

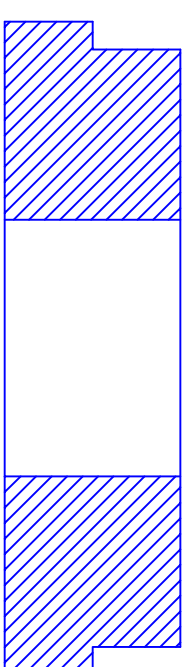

TOP PLATE  
P/N 1320-0238-004

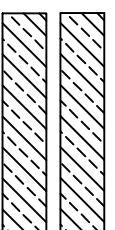

PACKOFF RUBBER (2)  
P/N 1320-0238-003



BOTTOM PLATE  
P/N 1320-0238-002

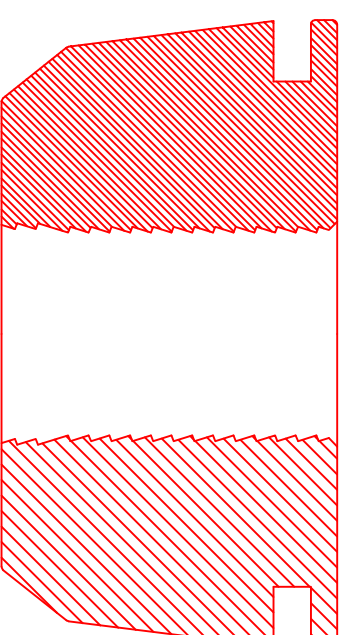

CASE HARDENED SLIPS  
P/N 1320-0238-001

- Notes:
1. DEBURR AND REMOVE ALL SHARP EDGES  
.015 X 45° UNLESS OTHERWISE NOTED
  2. PART TO BE FREE OF MACHINE OILS AND METAL CHIPS
  3. REFERENCE API 5B AND 11-IW

TOLERANCES UNLESS NOTED

DECIMAL	X.X	X.XX	X.XXX	ANGULAR SURFACE
	±.1	±.015	±.005	±.5° 125 rms



Wellhead Systems Inc.  
710 West McVey  
Hill City, Kansas 67642

Material:  
Ductile Iron  
(Per API 11-IW)

7" 8rd X 2-3/8 Type "A-7"  
Male Tubing Head  
All Dimensions ±.005 Unless  
Otherwise Stated

P/N 1371-0238-001