

5-1/2 8RD MALE
DUCTILE IRON BODY
P/N 1354-0000-030

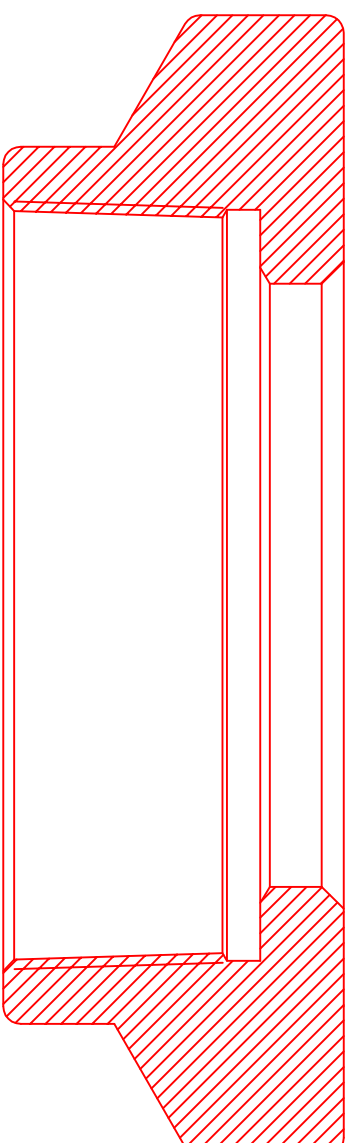

TOP CAP
P/N 1310-0000-016

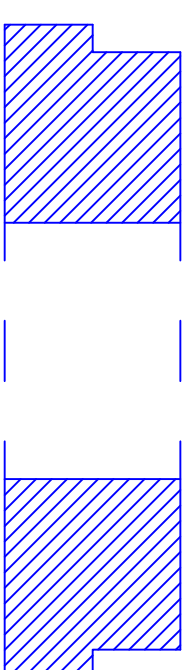

TOP PLATE
P/N 1325-0278-004



PACKOFF RUBBER (2)
P/N 1325-0278-003

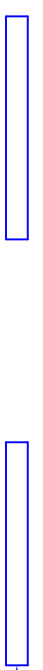

BOTTOM PLATE
P/N 1325-0278-002

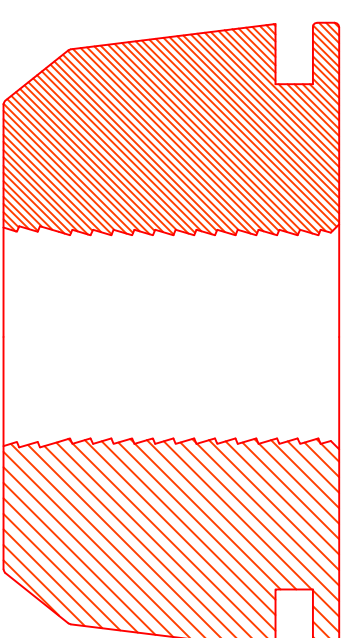

CASE HARDENED SLIPS
P/N 1325-0278-001

- Notes:
1. DEBURR AND REMOVE ALL SHARP EDGES
.015 X 45° UNLESS OTHERWISE NOTED
 2. PART TO BE FREE OF MACHINE OILS AND METAL CHIPS
 3. REFERENCE API 5B AND 11-IW

TOLERANCES UNLESS NOTED

DECIMAL	X.X	X.XX	X.XXX	ANGULAR SURFACE
	±.1	±.015	±.005	±.5° 125 rms



Wellhead Systems Inc.
710 West McVey
Hill City, Kansas 67642

Material:
Ductile Iron
(Per API 11-IW)

5- $\frac{1}{2}$ 8rd X 2- $\frac{7}{8}$ Type "A-7"
Male Tubing Head
All Dimensions ±.005 Unless
Otherwise Stated

P/N 1354-0278-001