

10- $\frac{3}{4}$ " SOW Body
Carbon Steel
P/N 9210-0000-031

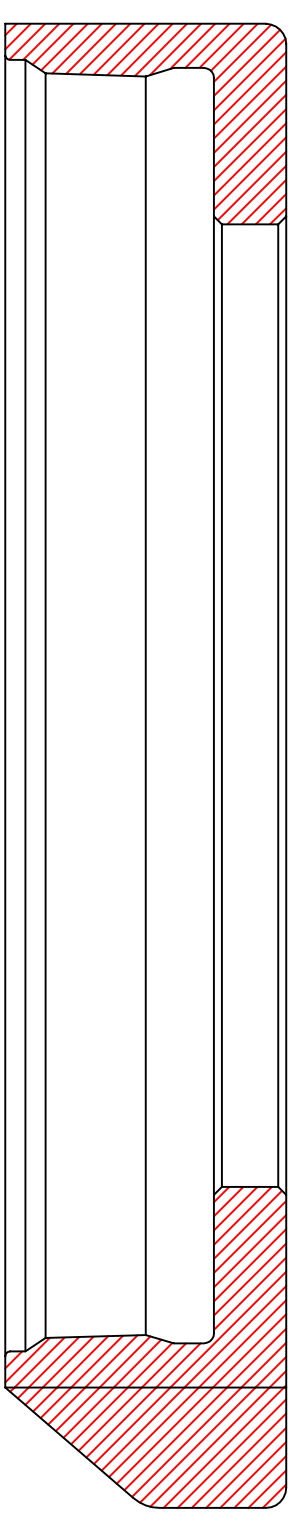

12- $\frac{3}{4}$ " 8V Top Cap
P/N 9210-0010-016

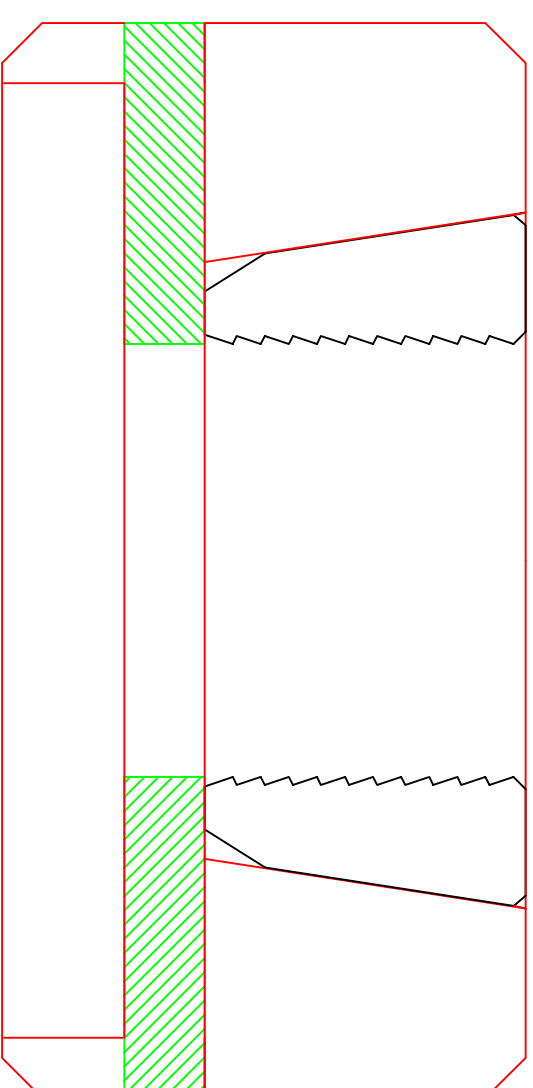

C-22 10- $\frac{3}{4}$ " X 5- $\frac{1}{2}$ " Hanger, Load Activated Slip Assembly.
Max. Load 250,000#
P/N 9210-0055-022

ALL THREADS ARE PER API SPECIFICATION 5B

Notes:

1. DEBURR AND REMOVE ALL SHARP EDGES
- .015 X 45° UNLESS OTHERWISE NOTED
2. PART TO BE FREE OF MACHINE OILS AND METAL CHIPS
3. REFERENCE API 5B AND 11-IW

TOLERANCES UNLESS NOTED

DECIMAL	X.X	X.XX	X.XXX	ANGULAR SURFACE
	±.1	±.015	±.005	±.5°
				125 rms



Wellhead Systems Inc.
710 West McVey
Hill City, Kansas 67642

Material:
WCC
(Per API 11-IW)

10- $\frac{3}{4}$ " X 5- $\frac{1}{2}$ " SDW Fig. 92
Casing Head C-22 Profile
All Dimensions ±.005 Unless
Otherwise Stated

4-3-09

P/N 9210-0055-031