

Model "SF" 7- $\frac{1}{16}$ 3M X 2- $\frac{7}{8}$ Complete Adapter
 P/N 0612-0278-088

Double Drilled
 P/N 0612-0278-288

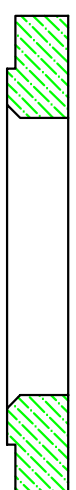

Model "SF" Bolt Set
 P/N 0612-0000-778



Model "SF" Top Gland Ring
 P/N 0612-0000-777

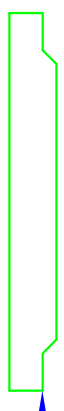

2- $\frac{7}{8}$ Model "SF" Top Plate
 P/N 0612-0000-278

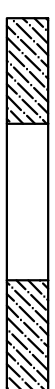

2- $\frac{7}{8}$ Model "SF" Packoff Rubber
 P/N 2325-0060-025



2- $\frac{7}{8}$ Model "SF" Bottom Plate
 P/N 2325-0061-025

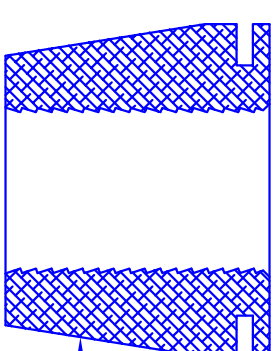

2- $\frac{7}{8}$ Model "SF" Slips
 P/N 3525-0000-250

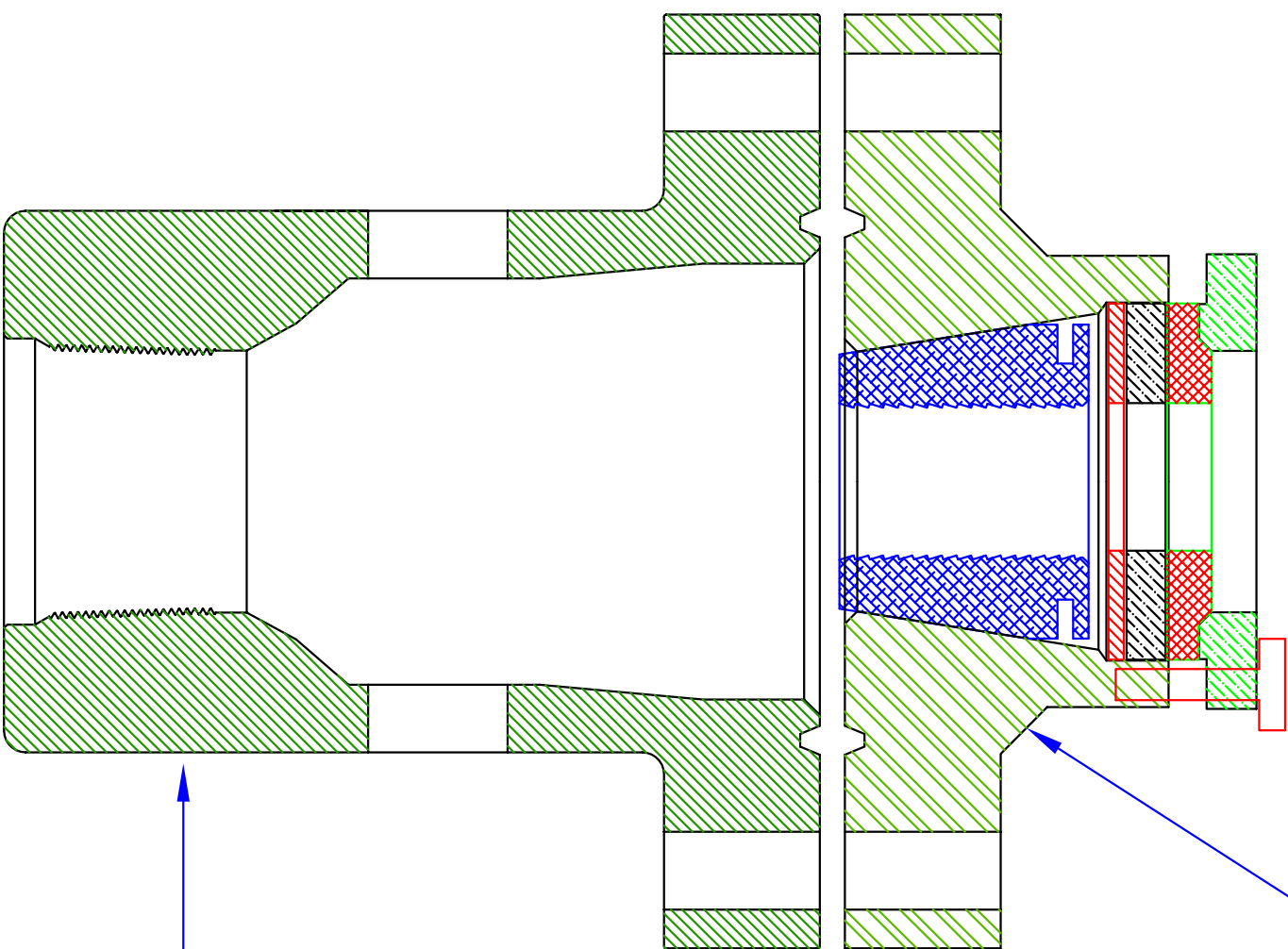

5- $\frac{1}{2}$ " 8rd 7- $\frac{1}{16}$ 3M Female Model "612"
 P/N 0612-0055-001

- Notes:
1. DEBURR AND REMOVE ALL SHARP EDGES
 .015 X 45° UNLESS OTHERWISE NOTED
 2. PART TO BE FREE OF MACHINE OILS AND METAL CHIPS
 3. REFERENCE API 5B AND 11-IW

TOLERANCES UNLESS NOTED

DECIMAL	X.X	X.XX	X.XXX	ANGULAR SURFACE
	±.1	±.015	±.005	±.5°
				125 rms



Wellhead Systems Inc.
 710 West McVey
 Hill City, Kansas 67642

Material:
 4130 API 70K
 (Per API 11-IW)

5- $\frac{1}{2}$ " 8rd 7- $\frac{1}{16}$ 3M X 2- $\frac{7}{8}$ "
 Model "612" w/ SF
 Attachment

02-16-10

P/N 0612-0278-588