

2" 11-1/2V (LP) X 1-1/8"
Model "B.S" Single Packed
Stuffing Box Complete

The Global Wellhead Systems Authority™



P/N: 0100-0200-125

CUSTOMER	PREPARED BY: Joe.H	PROJECT NO.	QUOTE NO:
PROJCET NAME	APPROVED BY:	DATE: 9/01/20	SHEET 1 OF 2

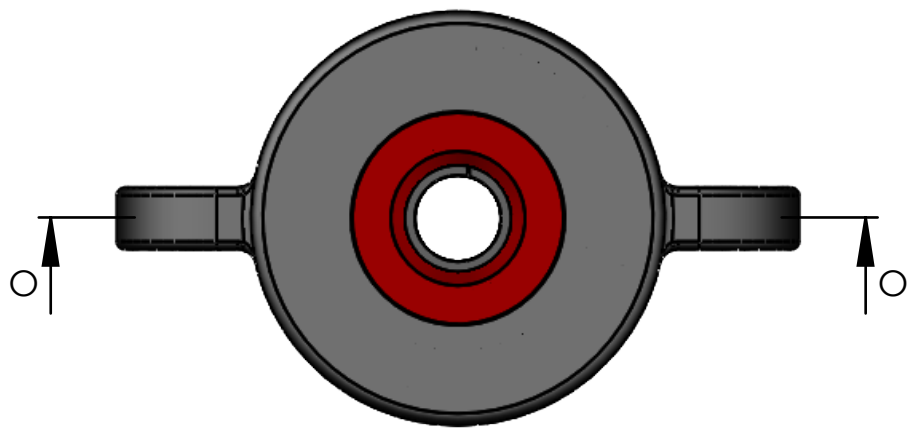

Model "B.S" Top Cap
(1,500PSI)

Upper Packing Ring (Ductile)
(1" - 1-5/16")

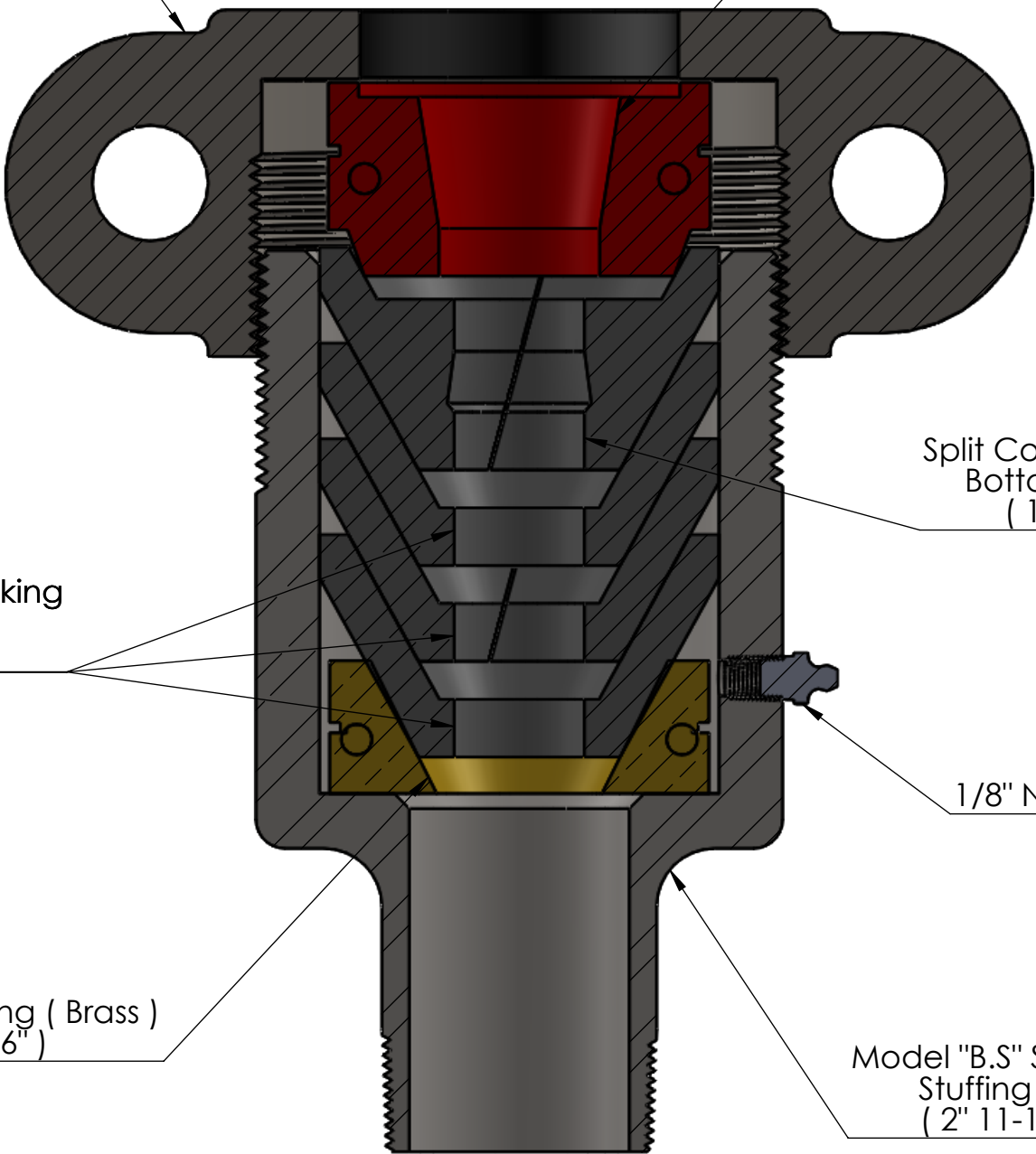

Split Cone Packing
Bottom Cone
(1-1/8")

Split Cone Packing
Top Cone
(1-1/8")

1/8" NPT Grease Zerk

Lower Packing Ring (Brass)
(1" - 1-5/16")

Model "B.S" Single Packed
Stuffing Box Body
(2" 11-1/2V (LP))

SECTION O-O

2" 11-1/2V (LP) X 1-1/8"
Model "B.S" Single Packed
Stuffing Box Complete

The Global Wellhead Systems Authority™



P/N: 0100-0200-125

CUSTOMER:	PREPARED BY: JOE.H	PROJECT NO.:	QUOTE NO.:
PROJECT NAME:	APPROVED BY:	DATE: 9/01/20	SHEET 2 OF 2