

Heavy Duty Application

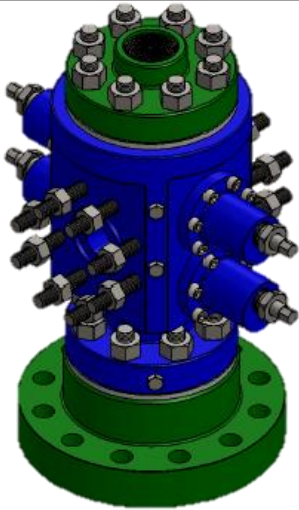

500F (Dual Ram Manual)

- 2-9/16" flange
- 5K Top X Bottom flange
- 2-1/16" studded side outlet or 2" LPO
- Rams: Blind, 1-1/4", 1-1/2" & 1-3/4"
- Standard NACE

500F (Exclusive Patented Design)

- Patented inner-locking ram design providing a mechanical seal and secondary safety factor when activated.
- Ram bolt designed to protect threads from services. Threads are cut on adjustment screw end versus on ram end.



500F (7-1/16" 3K, 5K or 10K Dual Ram)

- 7-1/16" flange X 2-9/16" 5K top
- 2-1/16" studded side outlet or 2" LPO
- Rams: Blind, 1-1/4", 1-1/2" & 1-3/4"
- Standard NACE

