

4- $\frac{1}{2}$  8RD FEMALE BODY  
 DUCTILE IRON  
 P/N 1444-0000-030

- Notes:
1. DEBURR AND REMOVE ALL SHARP EDGES  
 .015 X 45° UNLESS OTHERWISE NOTED
  2. PART TO BE FREE OF MACHINE OILS AND METAL CHIPS
  3. REFERENCE API 5B AND 11-IW

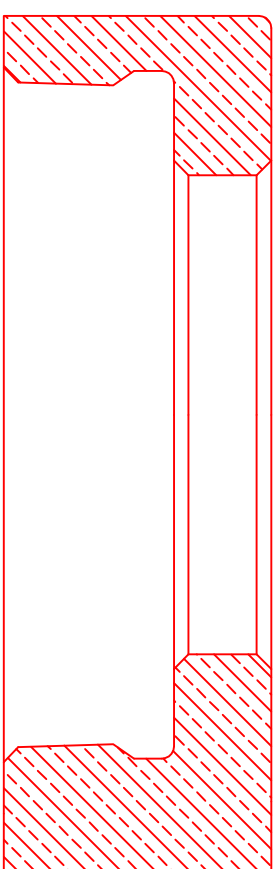

1410-0000-016

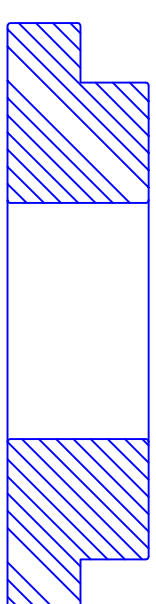

TOP PLATE  
 P/N 1420-0238-004



PACKOFF RUBBER (2)  
 P/N 1420-0238-003



BOTTOM PLATE  
 P/N 1420-0238-002

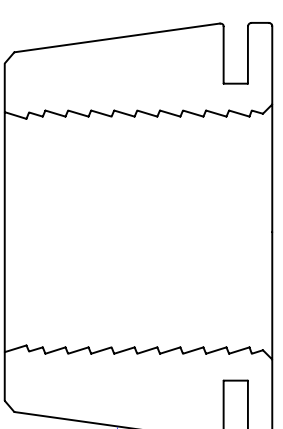

CASE HARDENED SLIPS  
 P/N 1420-0238-001

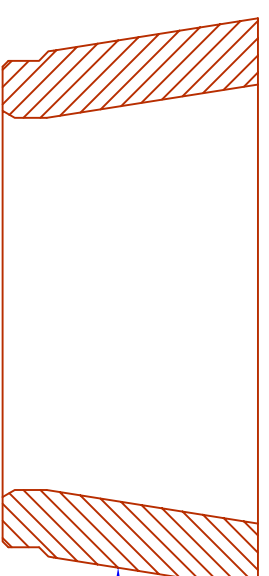

SLIP BOWL  
 P/N 1401-0000-001

TOLERANCES UNLESS NOTED

DECIMAL	X.X	X.XX	X.XXX	ANGULAR SURFACE
	±.1	±.015	±.005	±.5° 125 rms



Material:

Ductile Iron  
 65-45-12  
 (Per API 11-IW)

Wellhead Systems Inc.  
 710 West McVey  
 Hill City, Kansas 67642

4- $\frac{1}{2}$  8rd x 2- $\frac{3}{8}$  Female Type  
 "HB" Tubing Head  
 All Dimensions ±.005 Unless  
 Otherwise Stated

P/N 1444-0238-001