

7" 8RD MALE
 DUCTILE IRON BODY
 P/N 1371-0000-030

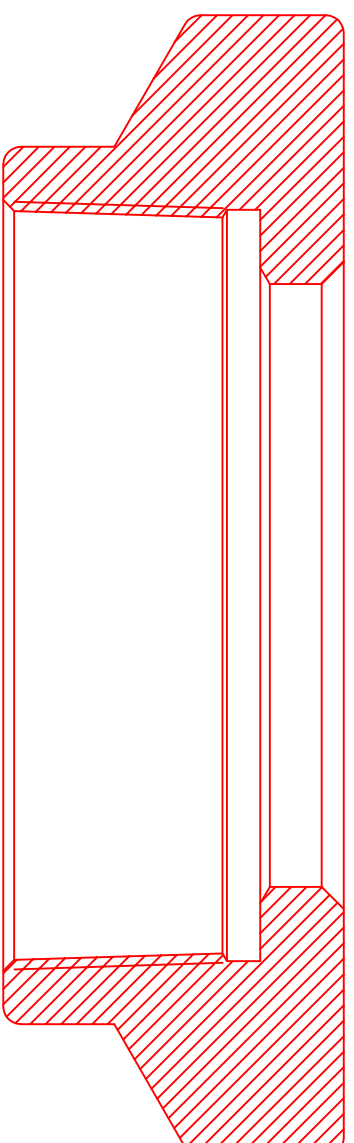

TOP CAP
 P/N 1310-0000-016

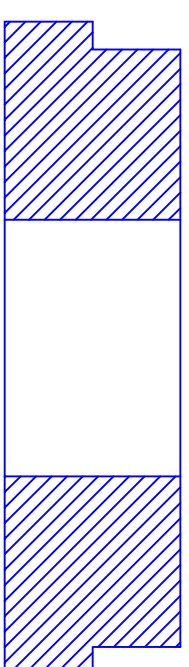

TOP PLATE
 P/N 1325-0278-004



PACKOFF RUBBER (2)
 P/N 1325-0278-003



BOTTOM PLATE
 P/N 1325-0278-002

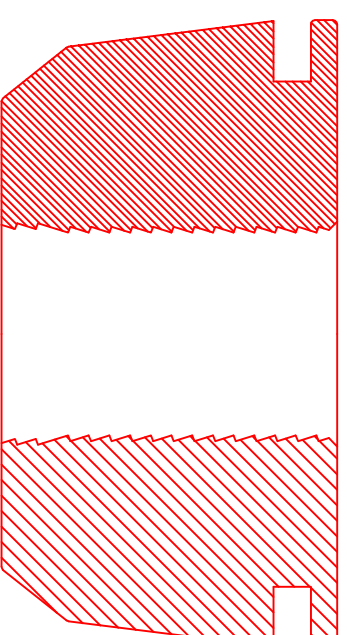

CASE HARDENED SLIPS
 P/N 1325-0278-001

- Notes:
1. DEBURR AND REMOVE ALL SHARP EDGES
 .015 X 45° UNLESS OTHERWISE NOTED
 2. PART TO BE FREE OF MACHINE OILS AND METAL CHIPS
 3. REFERENCE API 5B AND 11-IW

TOLERANCES UNLESS NOTED

DECIMAL	X.X	X.XX	X.XXX	ANGULAR SURFACE
	±.1	±.015	±.005	±.5° 125 rms



Wellhead Systems Inc.
 710 West McVey
 Hill City, Kansas 67642

Material:
 Ductile Iron
 (Per API 11-IW)

7" 8rd X 2-7/8 Type "A-7"
 Male Tubing Head
 All Dimensions ±.005 Unless
 Otherwise Stated

P/N 1371-0278-001