

7" 8RD FEMALE  
DUCTILE IRON BODY  
P/N 1370-0000-030

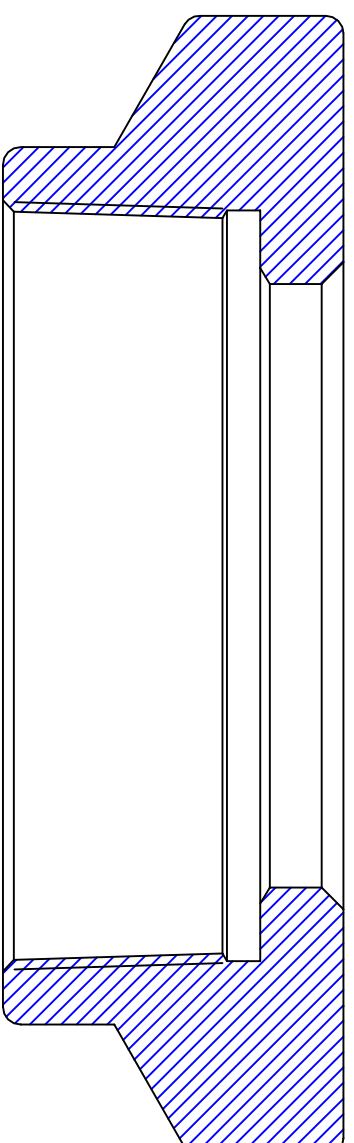

TOP CAP  
P/N 1310-0000-016

TOP PLATE  
P/N 1320-0238-004

PACKOFF RUBBER (2)  
P/N 1320-0238-003

BOTTOM PLATE  
P/N 1320-0238-002

CASE HARDENED SLIPS  
P/N 1320-0238-001

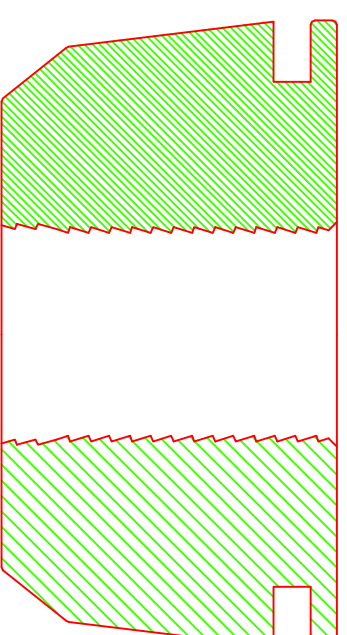

- Notes:
1. DEBURR AND REMOVE ALL SHARP EDGES  
.015 X 45° UNLESS OTHERWISE NOTED
  2. PART TO BE FREE OF MACHINE OILS AND METAL CHIPS
  3. REFERENCE API 5B AND 11-IW

TOLERANCES UNLESS NOTED

DECIMAL	X.X	X.XX	X.XXX	ANGULAR SURFACE
	±.1	±.015	±.005	±.5°
				125 rms



Wellhead Systems Inc.  
710 West McVey  
Hill City, Kansas 67642

Material:  
Ductile Iron  
(Per API 11-IW)

7" 8rd X 2-<sup>3</sup>/<sub>8</sub> Type "A-7"  
Female Tubing Head  
All Dimensions ±.005 Unless  
Otherwise Stated

P/N 1370-0238-001