

## BSDP "BS" Double Packed Stuffing Box

Before installation of BSDP, remove and liberally grease all packing (cone & V style) individually.

- Make sure to replace packing & all associated internal BSDP components as assembled from manufacturer.
- Make sure to stagger splits in cone packing when installing

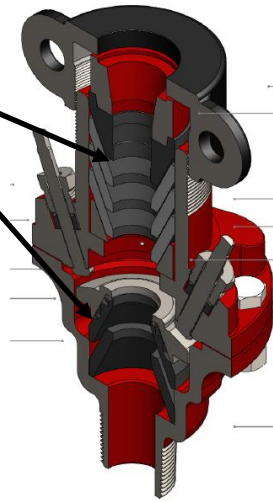

Before sliding BSDP onto polished rod, remove primary (4 cones) and tighten BSDP cap until a few threads engage to hold cap on while installing.

- BSDP  
Cap  
Follower

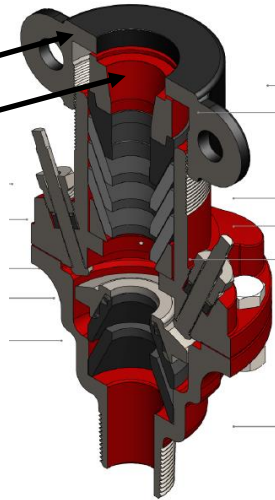

Slowly insert greased polished rod into BSDP box from bottom. Polished rod should slide through BSDP without restriction.

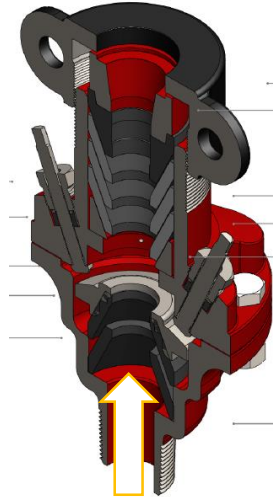

Thread BSDP into pumping tee and tighten until secure connection is achieved between the pumping tee and BSDP.

Remove Cap and install (greased) cone packing (4 pieces). Make sure that it is installed exactly as it was received from the factory in the inverted format and stagger splits to reduce chance of leakage.

NOTE: Be sure to use a high quality thread compound when making up stuffing box and pumping tee.

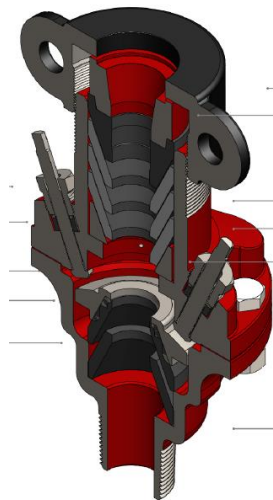

Once BSDP is installed into the pumping tee, tighten BSDP cap until it just touches the top follower.

- Do **NOT** tighten past this point
- NOTE: Over tightening will cause premature wear of packing.

- BSDP Cap & Follower

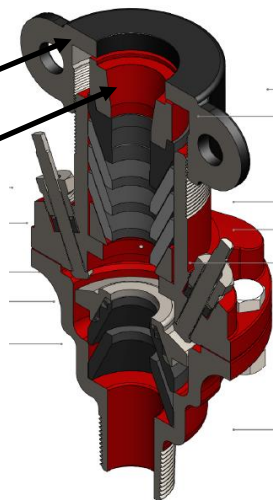

Start unit up and adjust BSDP cap only if necessary. You should have a slight film on polished rod as it reciprocates through the BSDP. If too much oil is on polished rod, make 1/8" turn adjustments to BSDP cap until you have proper film on polished rod.

- NOTE: ONLY BSDP cap should be used to adjust for packing wear.
- If necessary tightening adjustments may be necessary at the pumping tee and BSDP connection. Turn 1/4 turn at a time until no leaking occurs.

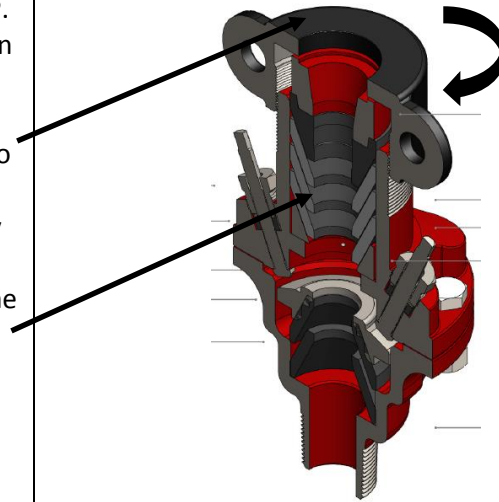

If using a polished rod lubricator, make sure that reservoirs are full of 30W or equivalent oil and **PRESOAK** the wicks prior to starting up pumping unit.

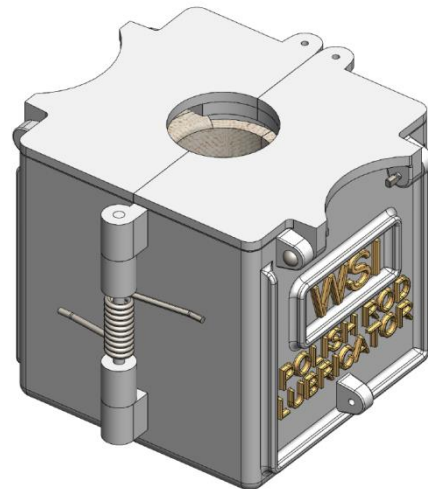

Packing adjustment, (if BSDP is properly maintained), should be achieved by simply turning BSDP cap by hand 1/8" at a time.

**NOTE: Again, over tightening will prematurely wear packing**